

# Vectus PRT Update from Suncheon Bay – October 2012

## Suncheon Bay's PRT

In recent months, real progress has been made in South Korea's Suncheon Bay concerning the construction of the necessary infrastructure for Vectus' much anticipated PRT system.

Vectus, a subsidiary of Korean steel giant POSCO, is currently building the first PRT network in the Asia Pacific region. Due to open for commercial service in time for the 2013 International Garden Expo, hosted by Korea for the first time, the 5km-long elevated link will serve the Coastal Wetlands Park on Suncheon Bay.



Station One

Above the depot and to the side, is a control room where all electrical and operational equipment is contained. From the large window, there are excellent views over Suncheon City.

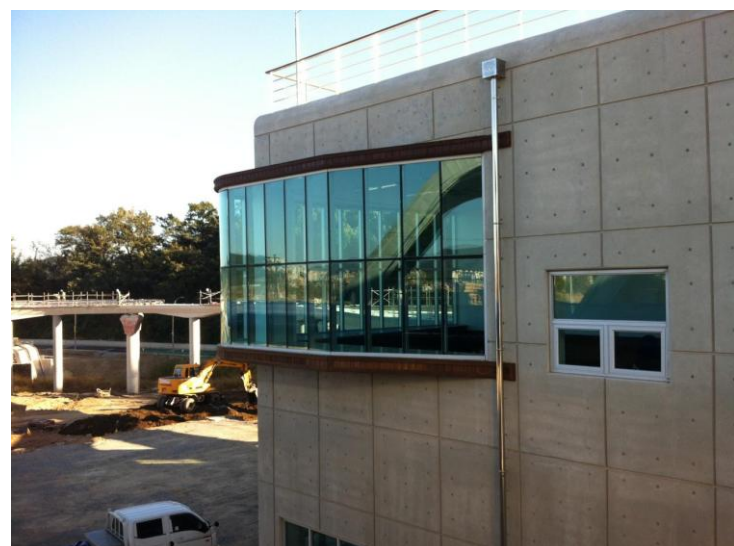

## Construction Nearing Completion at Suncheon Bay

Construction of the track, stations and depot is nearing completion in Suncheon Bay.

Station One has been built containing four in-line berths providing access to four vehicles via platform screen doors. These will be programmed to open in time with the doors of the vehicles, ensuring that customers alight safely and with ease.

The depot sits opposite Station One at the Suncheon City end of the system. A vehicle storage facility is situated on the ground floor of the depot. Daily and heavy maintenance takes place on the first floor with two off-line spurs to guide the vehicles in.



Exterior views of the control room and depot

# Vectus PRT Update from Suncheon Bay – October 2012

## The PRT Track

A double track will be in operation between the two stations with a single loop system at the end. The track loop is clearly visible from the control room (right).

Steel tracks have been mounted onto the concrete guideway, providing optimum low-friction interface to the vehicles.

The vehicles are electrically powered via a 500 VDC current collection system for high performance and continuous operation throughout the day. Once the vehicles are in operation, this system will provide quiet, comfortable and eco-friendly transport for the three million annual visitors to the reserve.



View of the track loop from the control room



Steel track being laid onto the concrete guideway

Station Two is currently under construction and due to be completed by the end of December 2012. Both stations will feature in-line berths, platform screen doors and touch screen passenger information/destination selection facilities.



Station Two



The main guideway to Station Two

Forty vehicles will operate along five kilometres of elevated, double tracked guideway.

With Suncheon Bay situated in a region of seismic activity and typhoons, and suffering from poor ground conditions, extensive piling has been necessary.

Concrete pillars were sunk thirty metres into the ground, thirty metres apart, with a larger span over the river.